

GEZE Perlan 140 telescopic for 3-leaf external applications

GEZE Perlan 140 telescopic is the elegant, space-saving roller-guided sliding system for extensive and spacious passages. It offers reliable protection from sunlight in combination with sliding shutters. High-quality bearings and a sturdy track guarantee a greater life span. The telescope set can easily be pre-assembled on the sliding elements. Perlan 140 telescopic is available as a complete accessory set for a 2-leaf system. This contains all parts for the telescopic function. There is an extension set available for each further leaf. The GEZE installation tool or a sleeve tool is required for installation of the wire cable.



APPLICATION RANGE

- For wooden, plastic and glass leaves
- For 2-leaf or 3-leaf systems of up to 140 kg per leaf
- Leaf width between at least 475 mm and 1700 mm per leaf
- All other product features correspond to the Perlan 140 roller-guided sliding system

TECHNICAL DATA

Product features	GEZE Perlan 140 lower guides for sliding shutters
Leaf material	Wood, plastic, metal
Number of leaves	2-leaf, 3-leaf
Leaf weight (max.)	140 kg
Type of installation	Wall installation, ceiling installation
Telescope	•

• = yes

GEZE PERLAN 140 TELESCOPIC3-LEAF

OVERVIEW OF COMPONENTS

GEZE Perlan 140 telescopic for sliding shutters with three leaves



- 1 = Track Perlan 140
- 2 = End stop Perlan 140
- 3 = Roller carriage Perlan 140
- 4 = Fitting extension for telescope 3-leaf

- 5 = Fitting for telescope 2-leaf
- 6 = Wall/ceiling adapter for telescope
- 7 = Wooden leaf (on site)
- 8 = Clearance-free floor guide for wooden leaves

CROSS-SECTION DRAWINGS

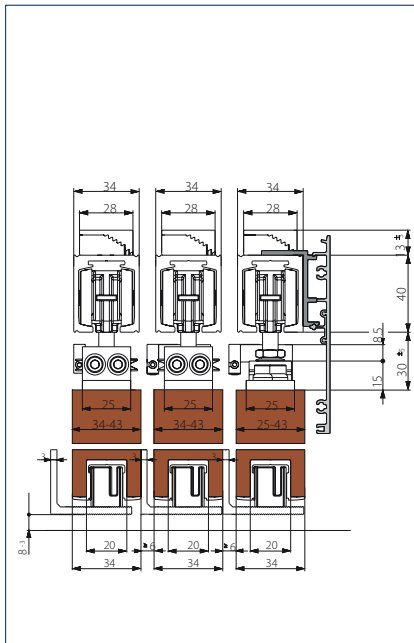

Ceiling mounting wood with spacer bracket and clip-on cover 100

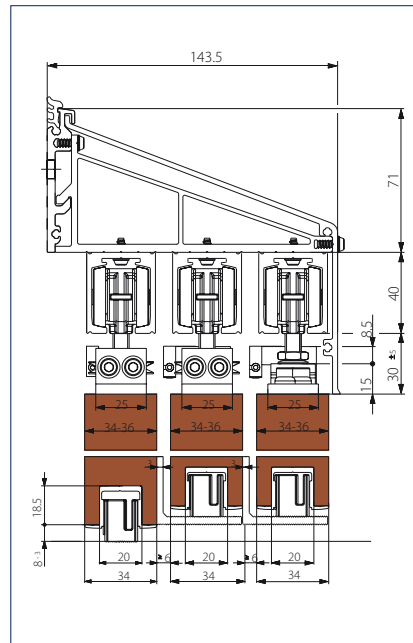

Wall mounting wood with wall bracket and weather canopy

ORDER INFORMATION

Description	Length	Version	ID No.
Perlan telescope set, 2-leaf For the telescopic movement of wooden leaves, comprising: complete telescope mechanism with installation material, wire cable 3.8 m, including 4 x suspension plate Perlan 140 KS			130891
Perlan telescope set, extension 3-leaf For extension by a 3rd leaf, including 2 x suspension plate Perlan 140 KS			130892
Accessories			
Mounting tool for cable riveting For the riveting of the wire cable for Perlan telescope Duosync			134035
M form floor guide	6000 mm	EV1	124661
Continuous floor guide Omega form	6000 mm	EV1	124640
Clearance-free floor guide With attachment material			123514
Buffer for continuous floor guide			124655
Buffer for continuous glass floor guide			124656
Angled floor guide 100 mm With attachment material			123513
Angled floor guide 40 mm With attachment material			123511
Angled floor guide 60 mm With attachment material			123512